

UNI-PRODUCTS, INC.
3315 Elkhorn Blvd North Highlands, Ca 95660
(916) 348-3800 Fax (916) 348-3700

ROOF CURBS FOR RHEEM UNITS

ADJUSTABLE PITCHED CURBS *

Product # MSMP2CS - Fits Units: RRKA, RSKA, RRNL0-B, RRPL 1 ½ - 5 Ton
RRMA, RSMA 1 ½ - 4 Ton RRNA, RSNA 2, 2 ½ & 3 Ton

Product # MSMP2CL - Fits Units: RKNA, RKNL, RKPL, RJKA, RJNA 3 – 5 Ton
RJNL, RJPL, RLNA, RLNL, RLPL 3 – 5 Ton
RKKA, RLKA 3 – 6 Ton

Product # MSMP2DS - Fits Units: RQKA 1 ½ - 4 Ton, RQMA1 ½ -3 Ton RQNA-B 2 - 4 Ton

FLAT CURBS **

Product # MSMP21842C - Fits Units: RRKA, RSKA, RRNL-B, RRPL 1 ½ - 5 Ton
RRMA, RSMA 1 ½ - 4 Ton RRNA, RSNA 2, 2 ½ & 3 Ton

Product # MSMP23672C - Fits Units: RKNA, RKNL, RKPL, RJKA, RJNA 3 – 5 Ton
RJNL, RJPL, RLNA, RLNL, RLPL 3 – 5 Ton
RKKA, RLKA 3 – 6 Ton

Product # MSMP21836D - Fits Units: RQKA 1 ½ - 4 Ton, RQMA1 ½ -3 Ton RQNA-B 2 - 4 Ton

FLAT COMMERCIAL CURBS**

Product # MSMP288 - Fits Units: RKMA, RLMA 6 Ton (High Efficiency 6 Ton only)
RKKA, RLKA 7 ½ Ton

Product # MSMP290150 - Fits Units: RJKB, RJMB, RKNB, RLNB 7 ½ - 10 Ton,
RKKB, RKMB, RLKB, RKMB 7 ½ - 12 ½ Ton,

Product # MSMP2180240 - Fits Units: RKKB, RKMB, RLKB, 15 –25 Ton

ADAPTACURBS

Product numbers and pricing are available @ Adaptacurb.com

* Patent # 5,454,538 & DES.431174

** All curbs are fully welded and assembled

06/15/08

UNI-PRODUCTS, INC.

3315 Elkhorn Blvd North Highlands Ca. 95660
 (800)369-7017 Fax (916)348-3700

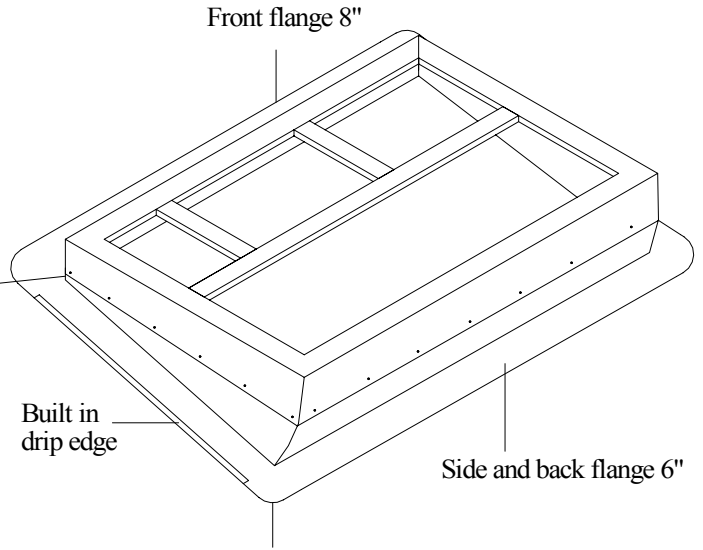
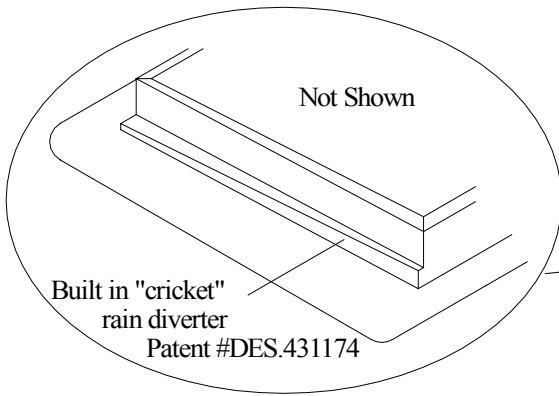

Patents # 5,454,538
 # DES. 431174

Curb construction :
 20 ga. G-90 galvanized steel
 Fully welded seams and corners
 Adjustable from a 2/12 up to a 6/12 pitch
 IAPMO / UMC listed
 Maximum load rating 800lbs.

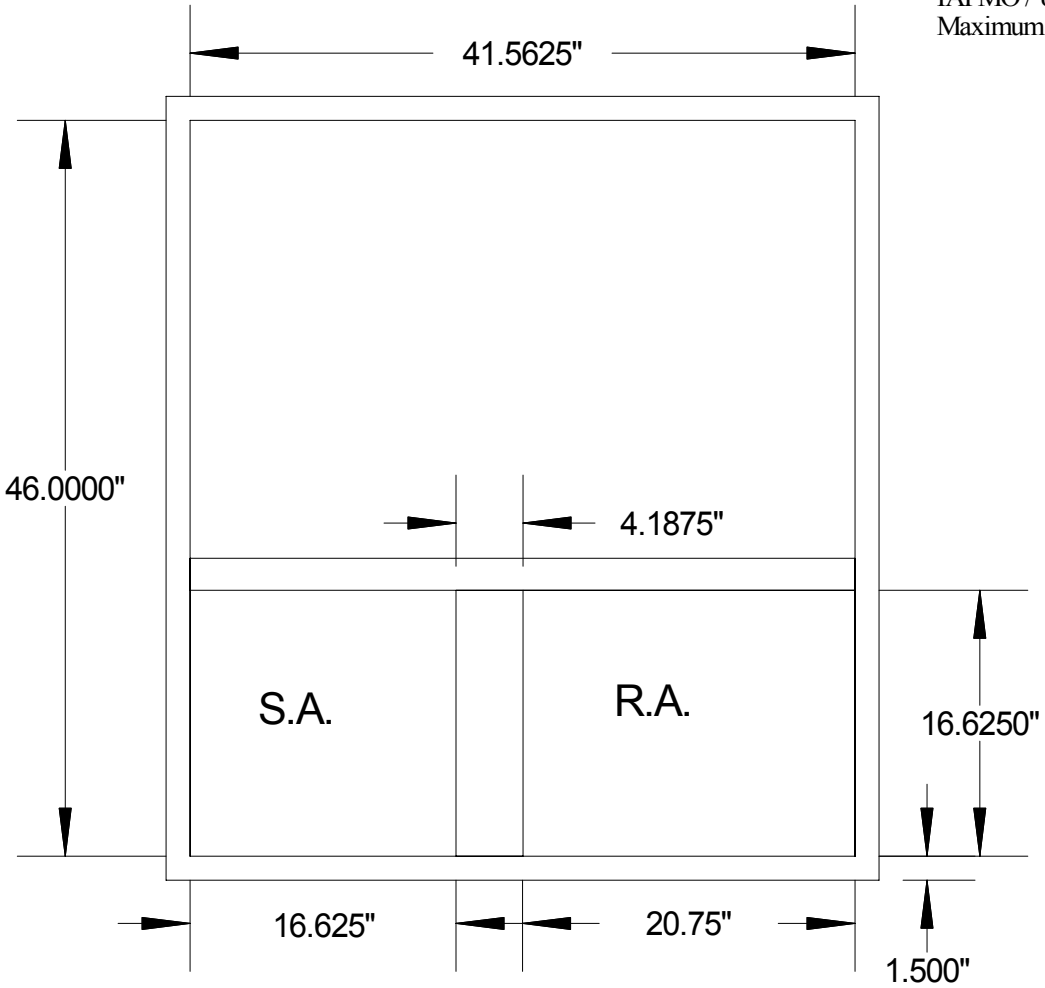

Product # MSMP2CS

UNI-PRODUCTS, INC.

3315 Elkhorn Blvd North Highlands Ca. 95660

(800)369-7017 Fax (916)348-3700

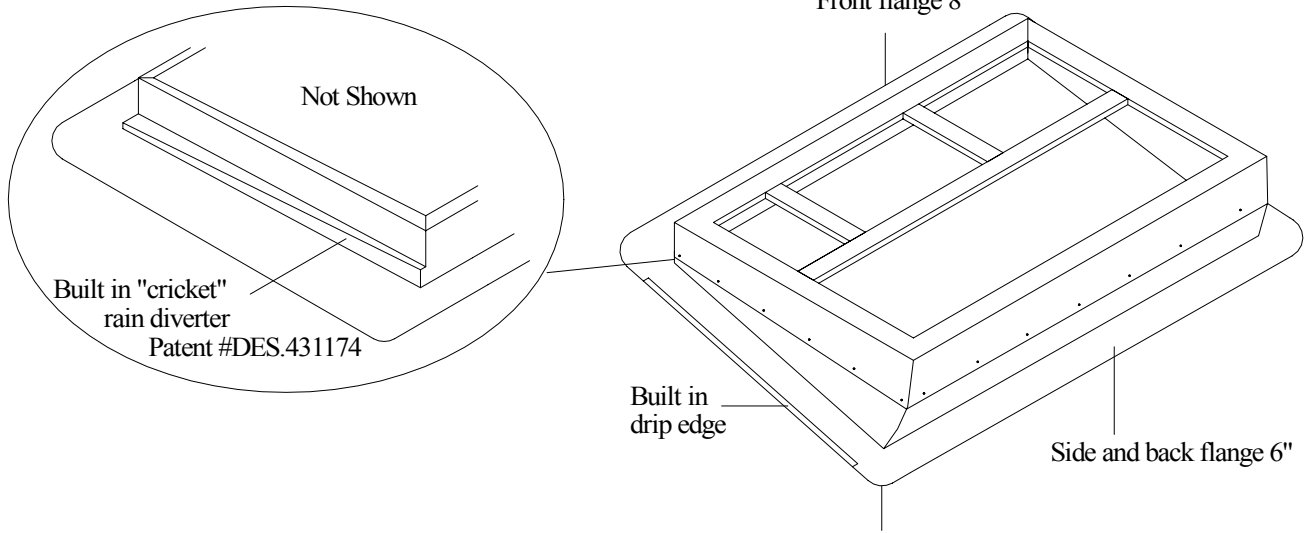

Patents # 5,454,538
DES. 431174

Rounded corners help prevent damage to roof shingles

Curb construction :
20 ga. G-90 galvanized steel
Fully welded seams and corners
Adjustable from a 2/12 up to a 6/12 pitch
IAPMO / UMC listed
Maximum load rating 800lbs.

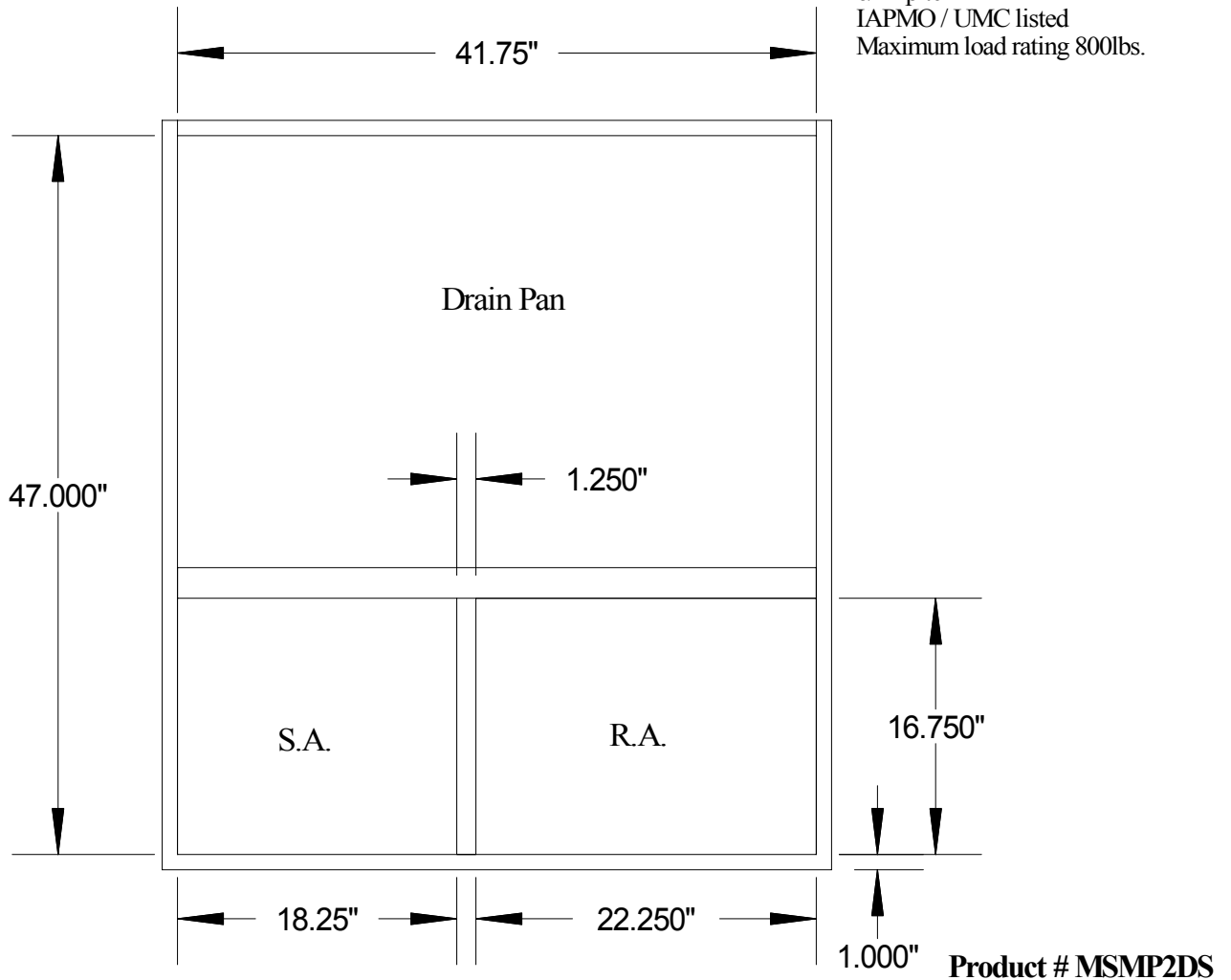

UNI-PRODUCTS, INC.

3315 Elkhorn Blvd North Highlands Ca. 95660
 (800)369-7017 Fax (916)348-3700

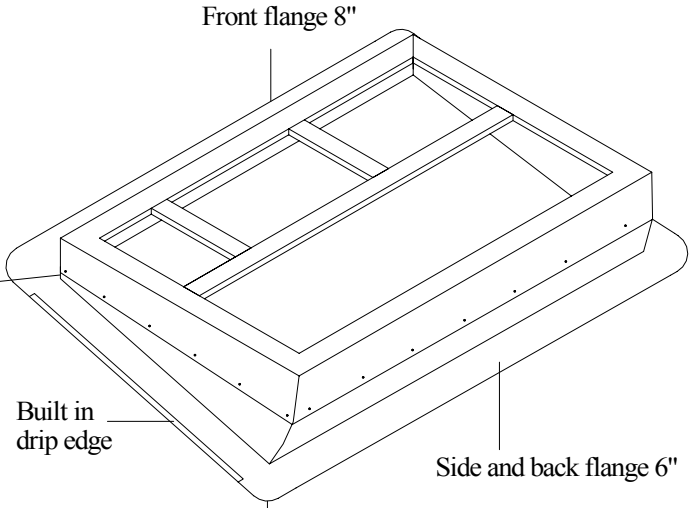
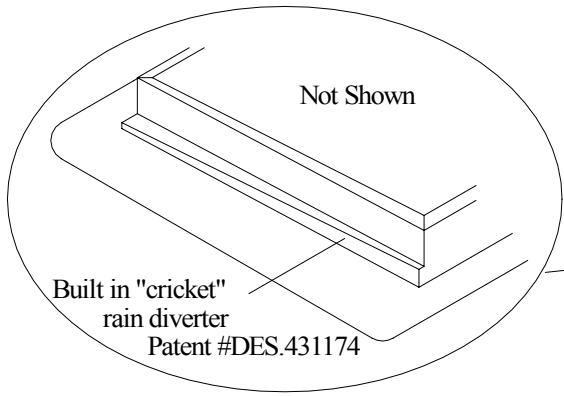

Rounded corners help prevent damage to roof shingles

Curb construction :
 20 ga. G-90 galvanized steel
 Fully welded seams and corners
 Adjustable from a 2/12 up to a 6/12 pitch
 IAPMO / UMC listed
 Maximum load rating 800lbs.

Patents # 5,454,538
 # DES. 431174

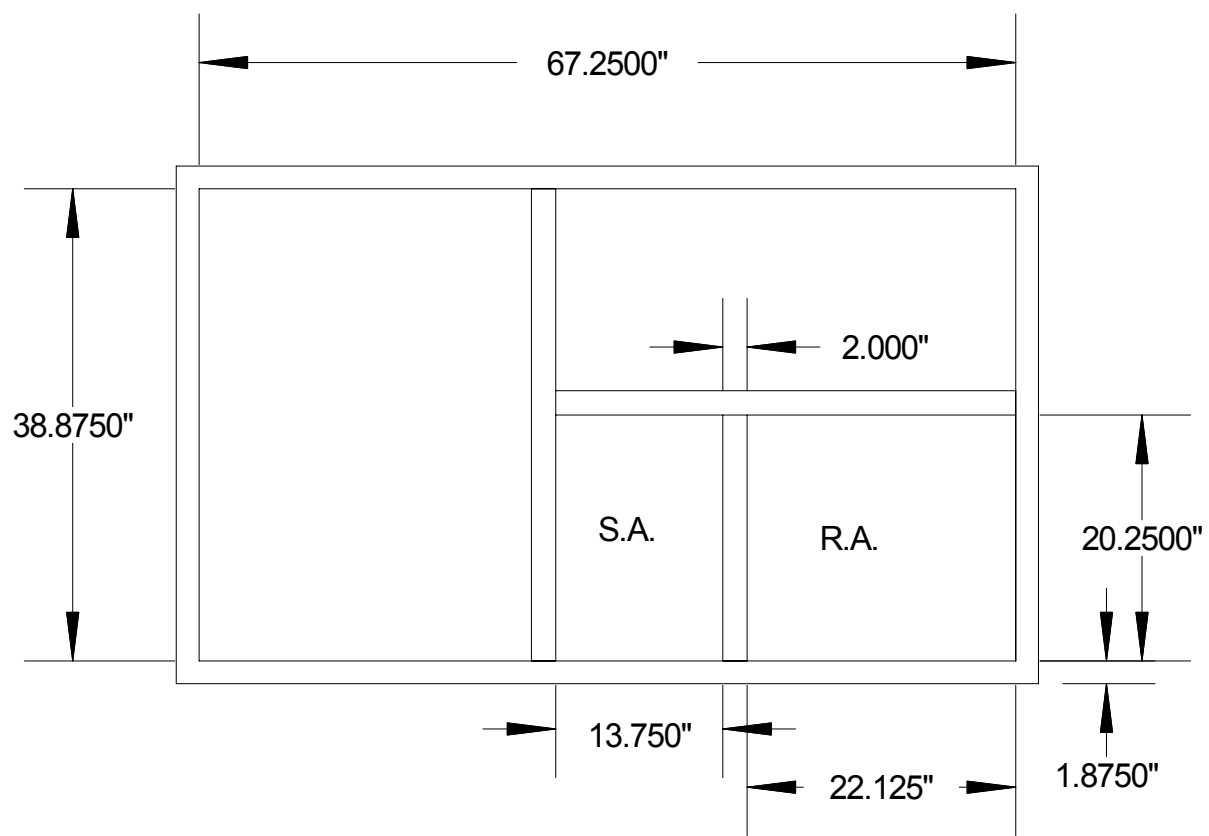

Product # MSMP2CL

UNI-PRODUCTS INC.
 3315 Elkhorn Blvd
 North Highlands Ca. 95660
 (800) 369-7017

Fits Our Product #'s
 MSMP2CS and MSMP21842C

S.A. plenum construction :
 28 ga. galvanized steel
 Button lock seams
 Insulated with 1/2" fiberglass
 insulation, glued and pinned
 Ship K.D. in three pieces, includes end cap

R.A. can construction :
 28 ga. galvanized steel 2" deep with solid bottom

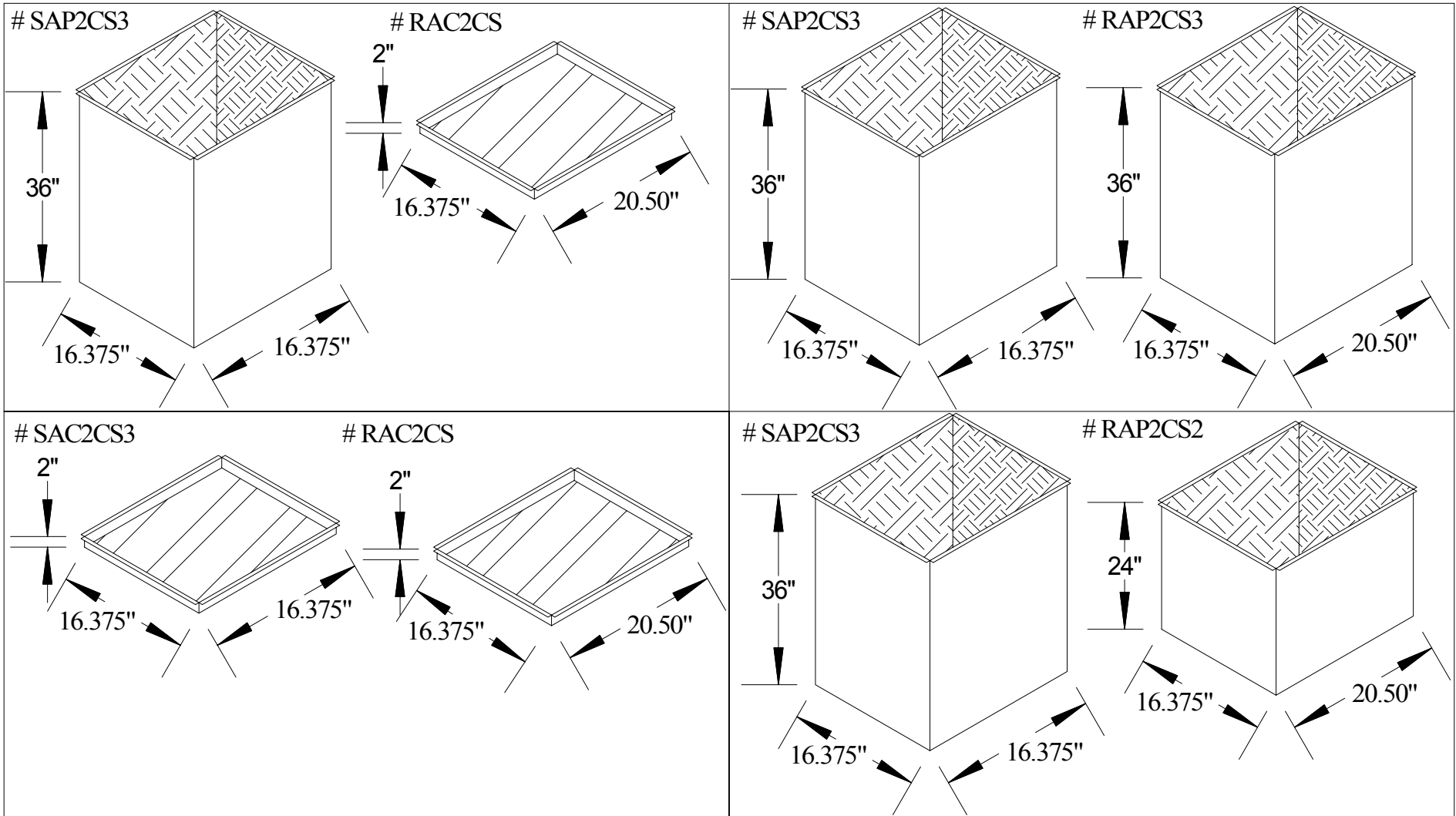

UNI-PRODUCTS INC.
 3315 Elkhorn Blvd
 North Highlands Ca. 95660
 (800) 369-7017

Fits Our Product #'s
 MSMP2DS and MSMP21836D

S.A. plenum construction :
 28 ga. galvanized steel
 Button lock seams
 Insulated with 1/2" fiberglass
 insulation, glued and pinned
 Ship K.D. in three pieces, includes end cap

R.A. can construction :
 28 ga. galvanized steel 2" deep with solid bottom

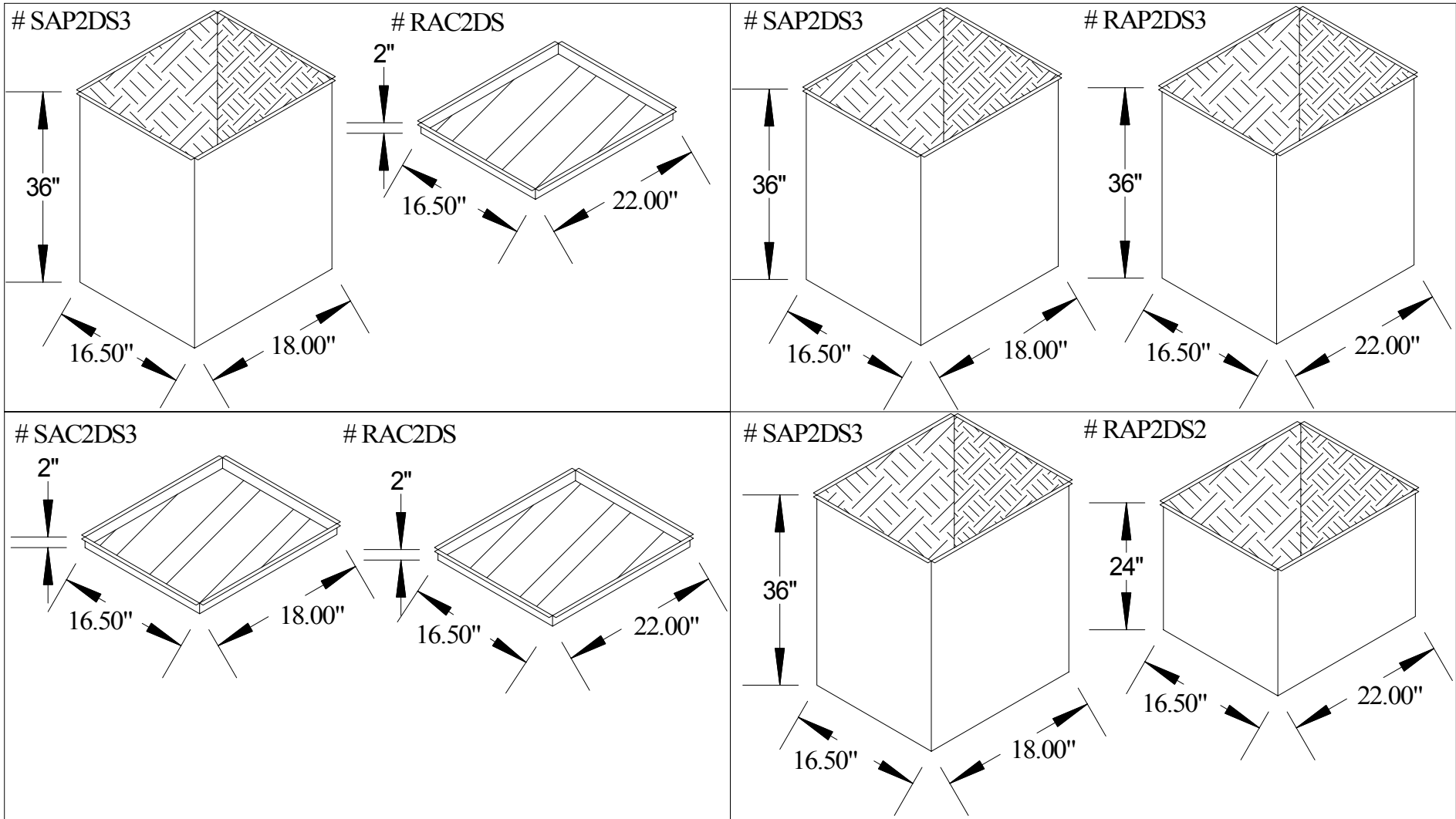

UNI-PRODUCTS INC.
 3315 Elkhorn Blvd
 North Highlands Ca. 95660
 (800) 369-7017

Fits Our Product #'s
 MSMP2CL and MSMP23672C

S.A. plenum construction :
 28 ga. galvanized steel
 Button lock seams
 Insulated with 1/2" fiberglass
 insulation, glued and pinned
 Ship K.D. in three pieces, includes end cap

R.A. can construction :
 28 ga. galvanized steel 2" deep with solid bottom

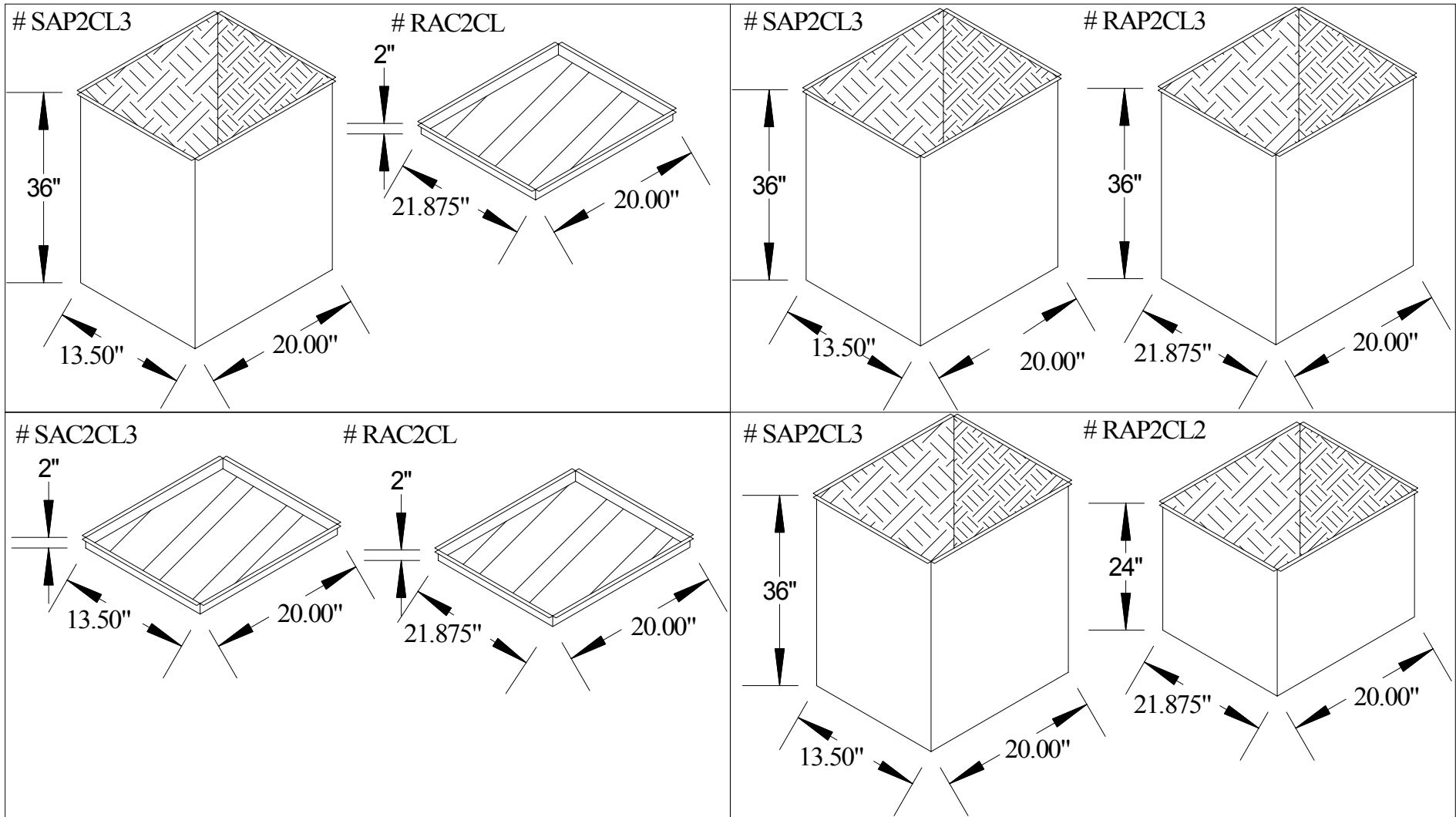

UNI-PRODUCTS, INC.

3315 Elkhorn Blvd North Highlands Ca. 95660
(800)369-7017 Fax (916)348-3700

Curb construction - 20 Ga. G-90 galvanized steel.
Fully welded seams and corners.
Curbs ship with closed cell neoprene
gasket material to create an air tight
seal between the curb and unit.

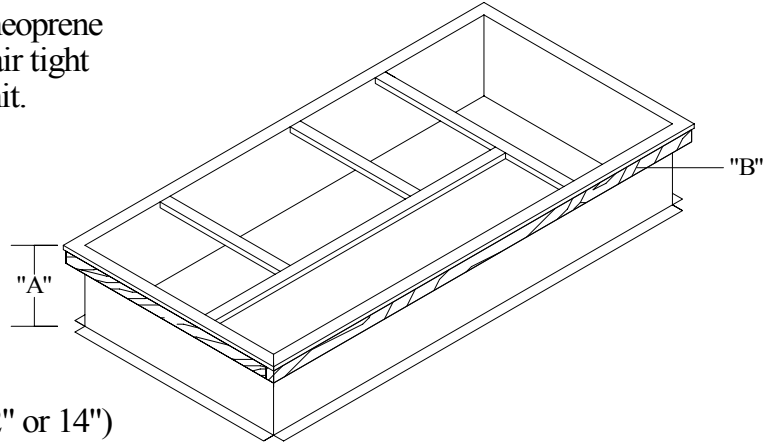

A = Curb height (standard curb height 8" , 12" or 14")
special curb height available upon request.

B = 1" x 4" wood nailer

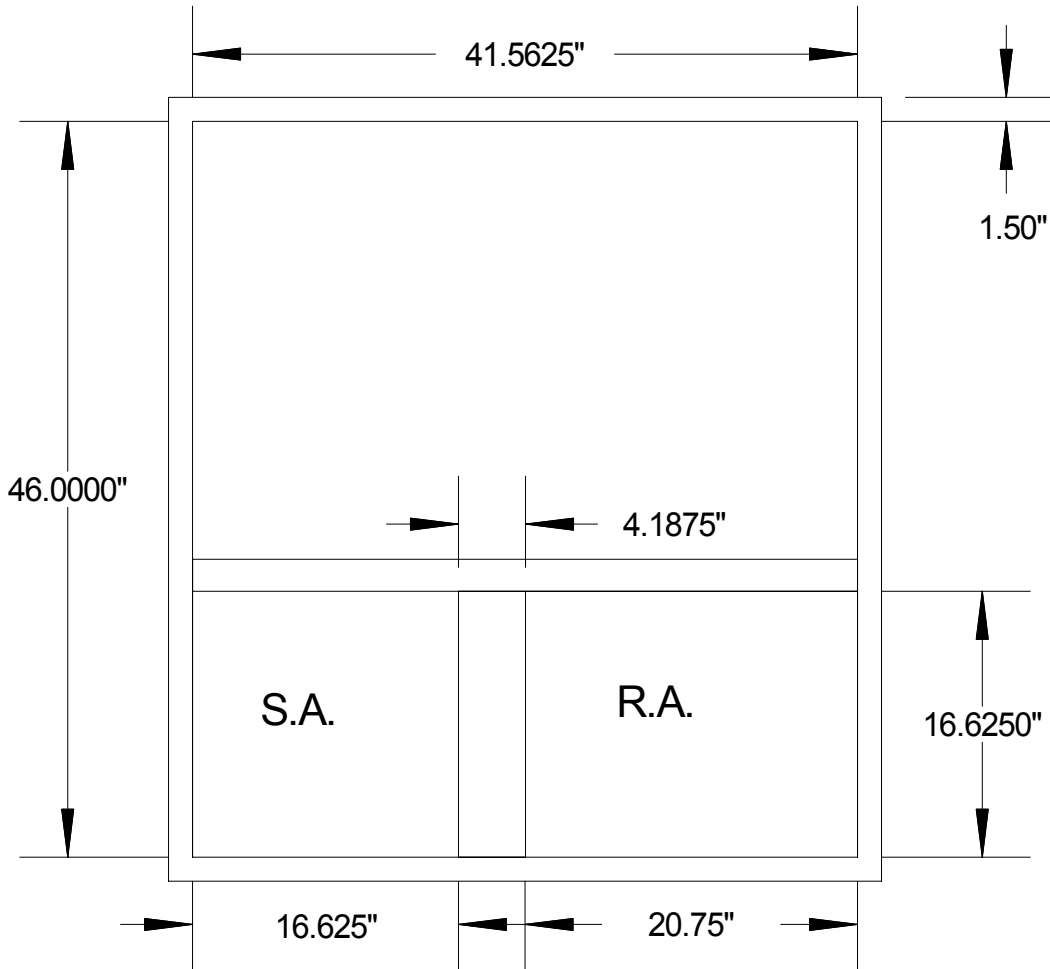

Product # MSMP21842C

UNI-PRODUCTS, INC.
 3315 Elkhorn Blvd North Highlands Ca. 95660
 (800)369-7017 Fax (916)348-3700

Curb construction - 20 Ga. G-90 galvanized steel.
 Fully welded seams and corners.
 Curbs ship with closed cell neoprene gasket material to create an air tight seal between the curb and unit.

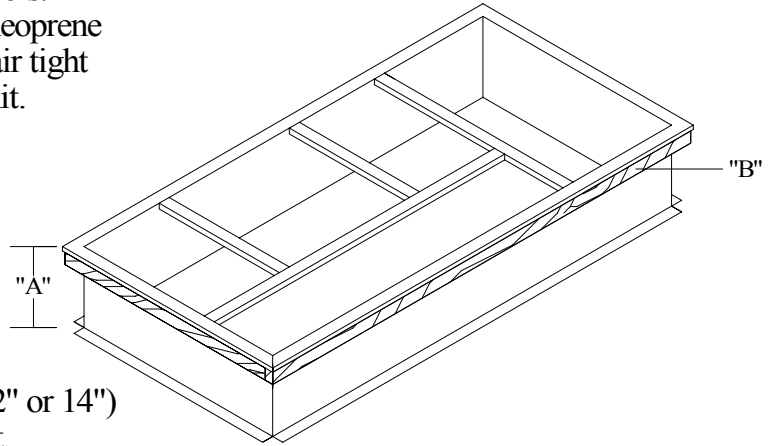

A = Curb height (standard curb height 8" , 12" or 14")
 special curb height available upon request.

B = 1" x 4" wood nailer

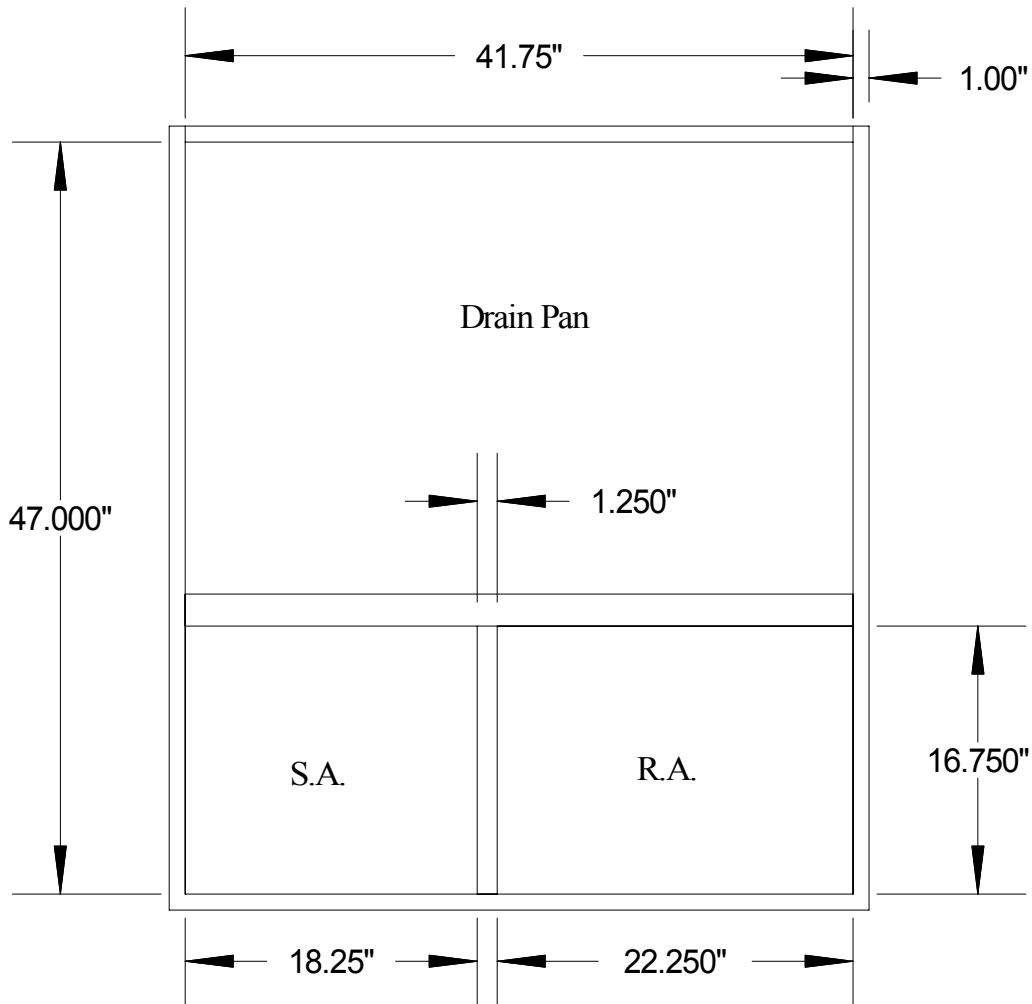

Product # MSMP21836D

UNI-PRODUCTS, INC.

3315 Elkhorn Blvd North Highlands Ca. 95660
(800)369-7017 Fax (916)348-3700

Curb construction -18 Ga. G-90 galvanized steel.
Fully welded seams and corners.
Curbs ship with closed cell neoprene
gasket material to create an air tight
seal between the curb and unit.

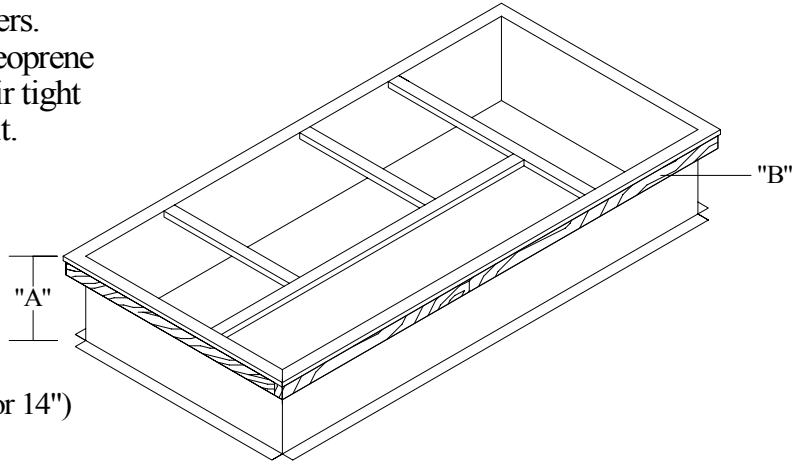

A = Curb height (standard curb height 8" , 12" or 14")
special curb height available upon request.

B = 2" x 4" wood nailer

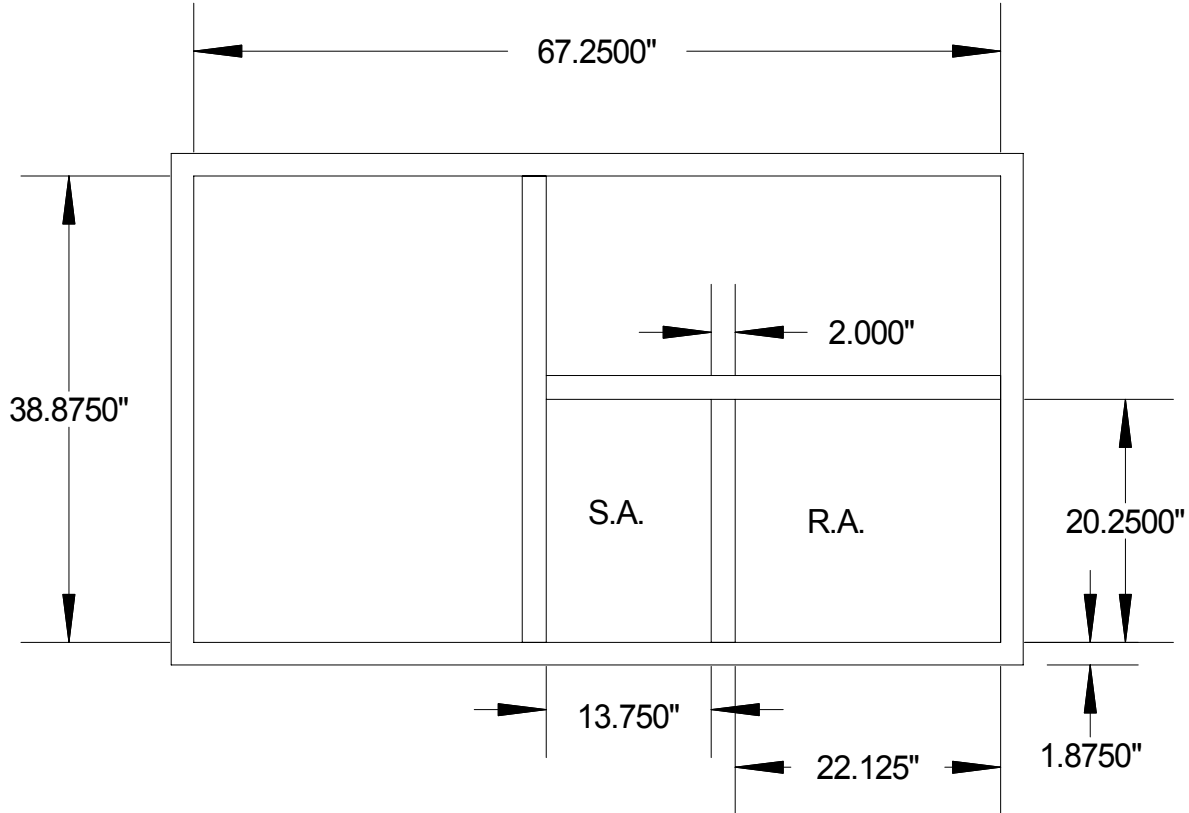

Product # MSMP23672C

UNI-PRODUCTS, INC.

3315 Elkhorn Blvd North Highlands Ca. 95660

(800)369-7017 Fax (916)348-3700

Curb construction -18 Ga. G-90 galvanized steel.
Fully welded seams and corners.
Curbs ship with closed cell neoprene
gasket material to create an air tight
seal between the curb and unit.

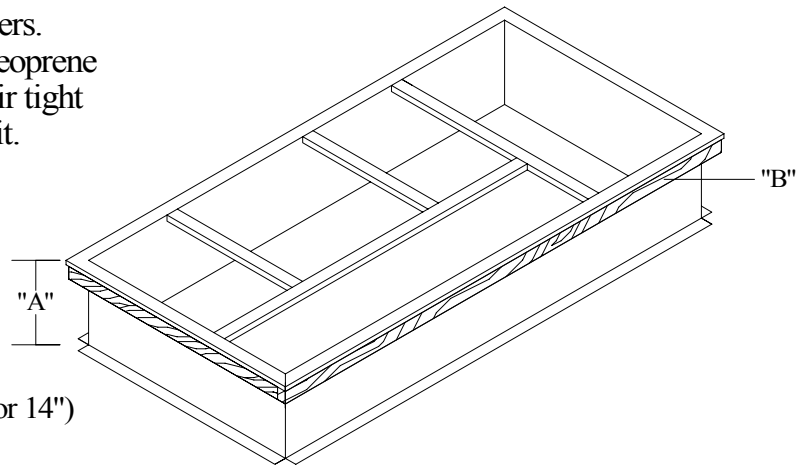

A = Curb height (standard curb height 8" , 12" or 14")
special curb height available upon request.

B = 2" x 4" wood nailer

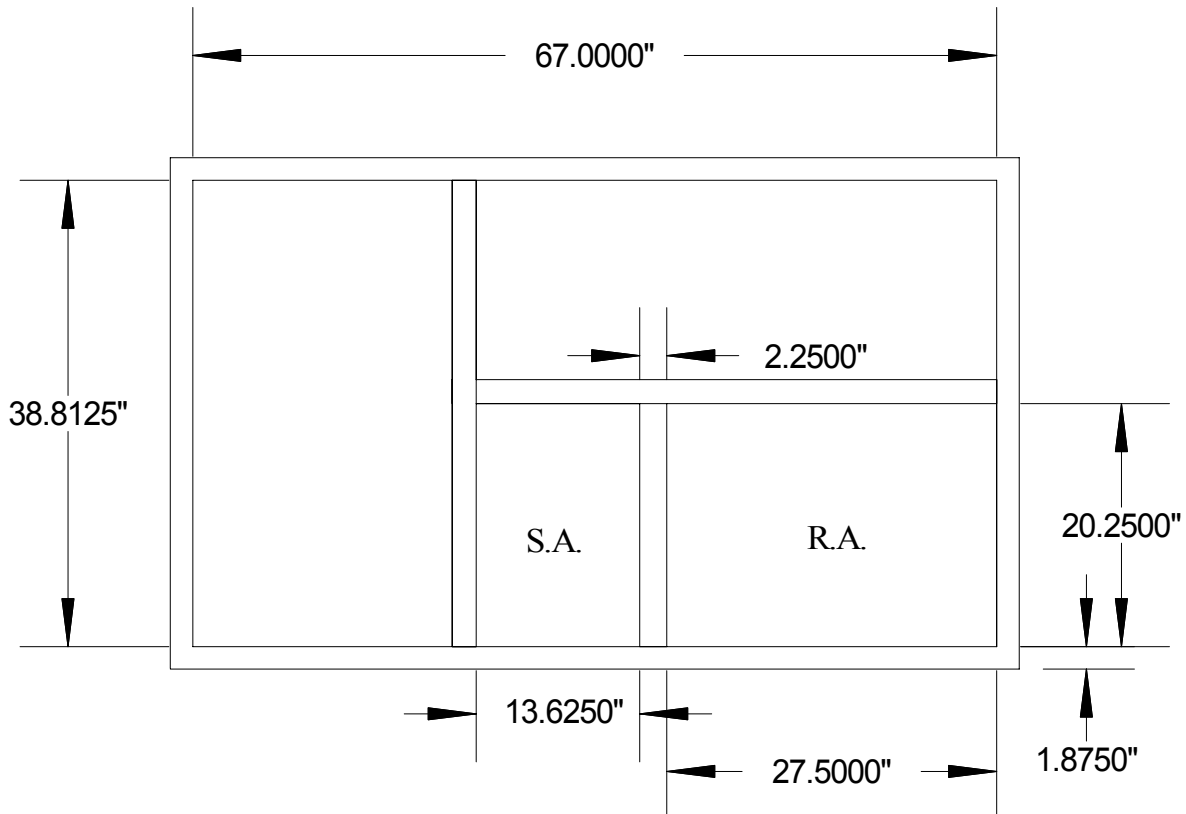

Product # MSMP288

UNI-PRODUCTS, INC.

3315 Elkhorn Blvd North Highlands Ca. 95660

(800)369-7017 Fax (916)348-3700

Curb construction -18 Ga. G-90 galvanized steel.
Fully welded seams and corners.
Curbs ship with closed cell neoprene
gasket material to create an air tight
seal between the curb and unit.

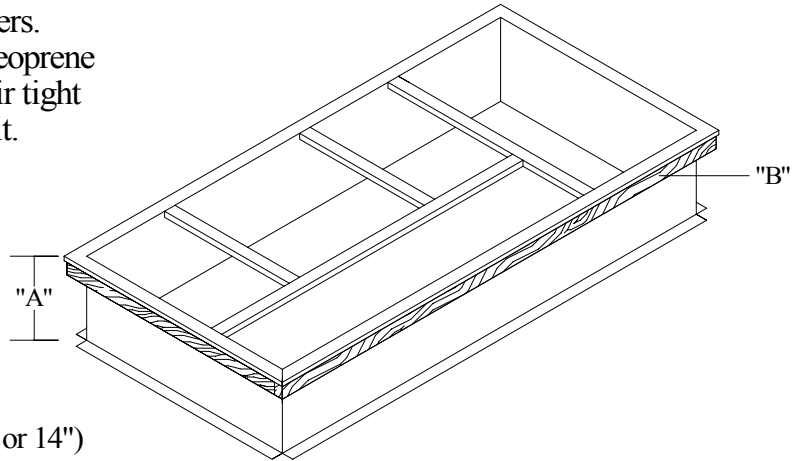

A = Curb height (standard curb height 8" , 12" or 14")
special curb height available upon request.

B = 2" x 4" wood nailer

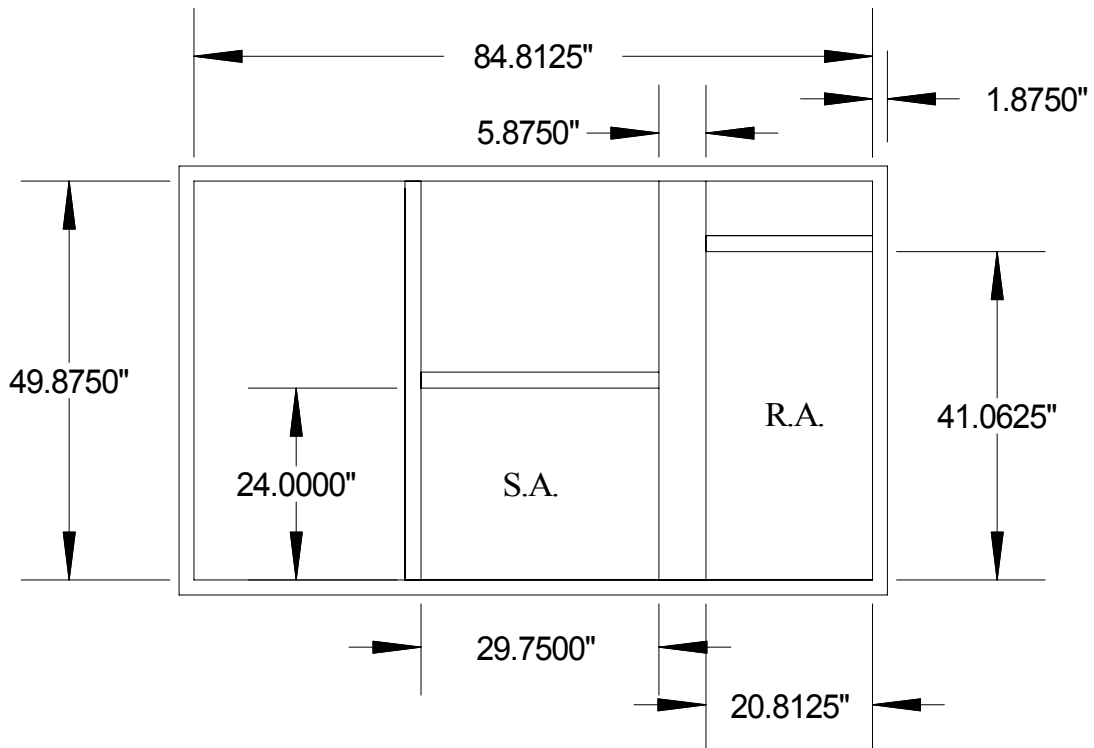

Product # MSMP290150

UNI-PRODUCTS, INC.
 3315 Elkhorn Blvd North Highlands Ca. 95660
 (800)369-7017 Fax (916)348-3700

Curb construction -16 Ga. G-90 galvanized steel.
 Fully welded seams and corners.
 Curbs ship with closed cell neoprene
 gasket material to create an air tight
 seal between the curb and unit.

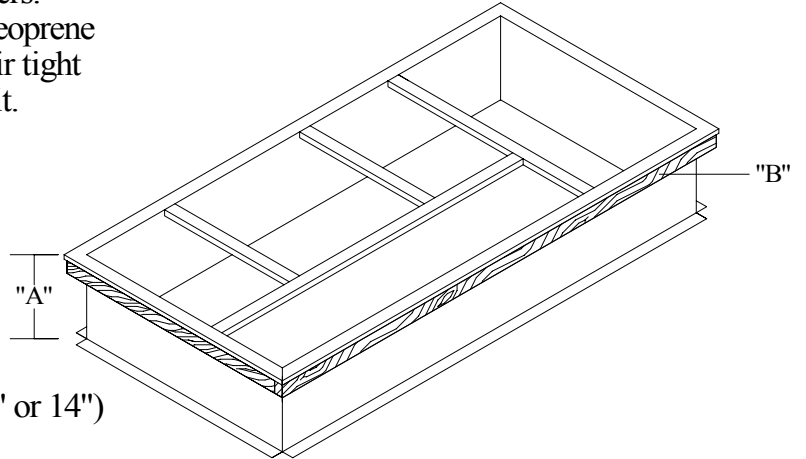

A = Curb height (standard curb height 8" , 12" or 14")
 special curb height available upon request.

B = 2" x 4" wood nailer

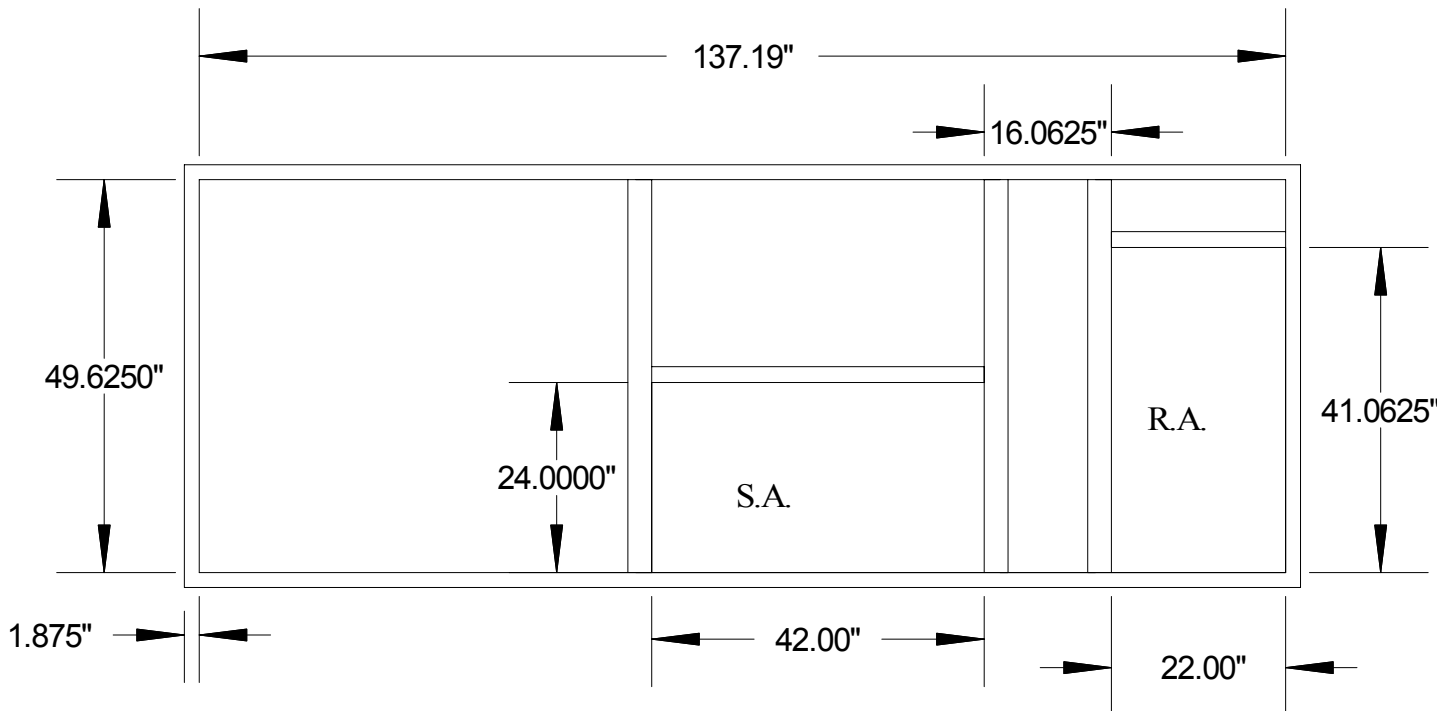

Min. Curb Height =	_____
Roof Pitch =	_____
Nailer Strip Req. - Y	<input type="checkbox"/> N
Ga. of Steel	_____

Pitch Direction Sheet

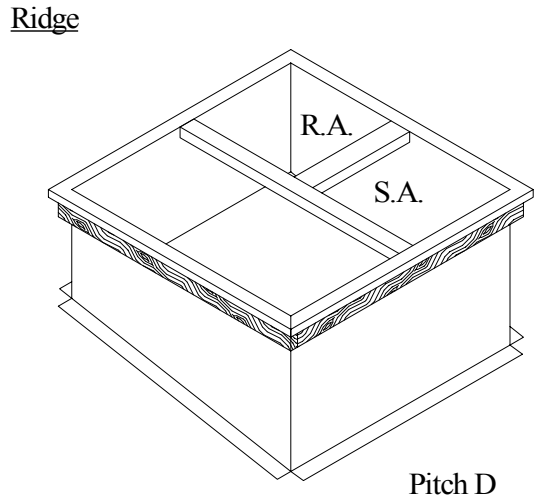
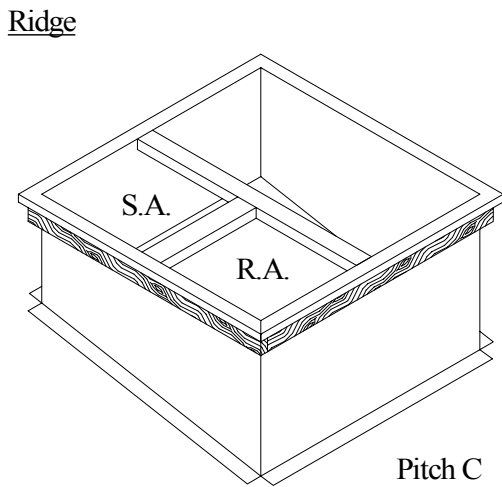
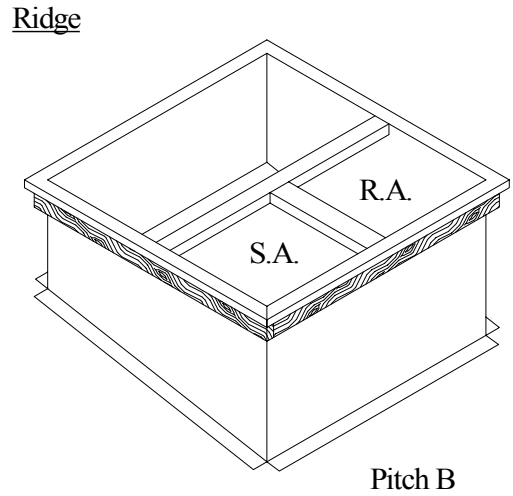
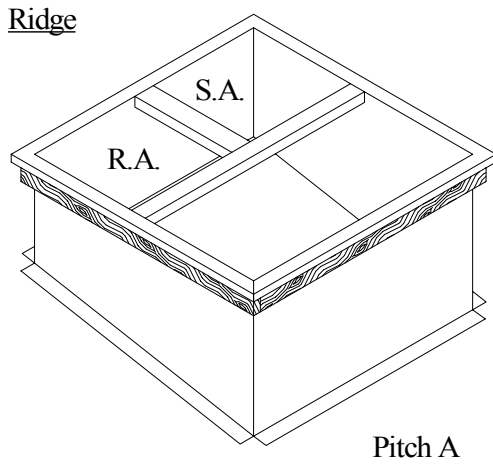

UNI-PRODUCTS, INC.

3315 Elkhorn Blvd North Highlands Ca. 95660

(800)369-7017 Fax (916)348-3700

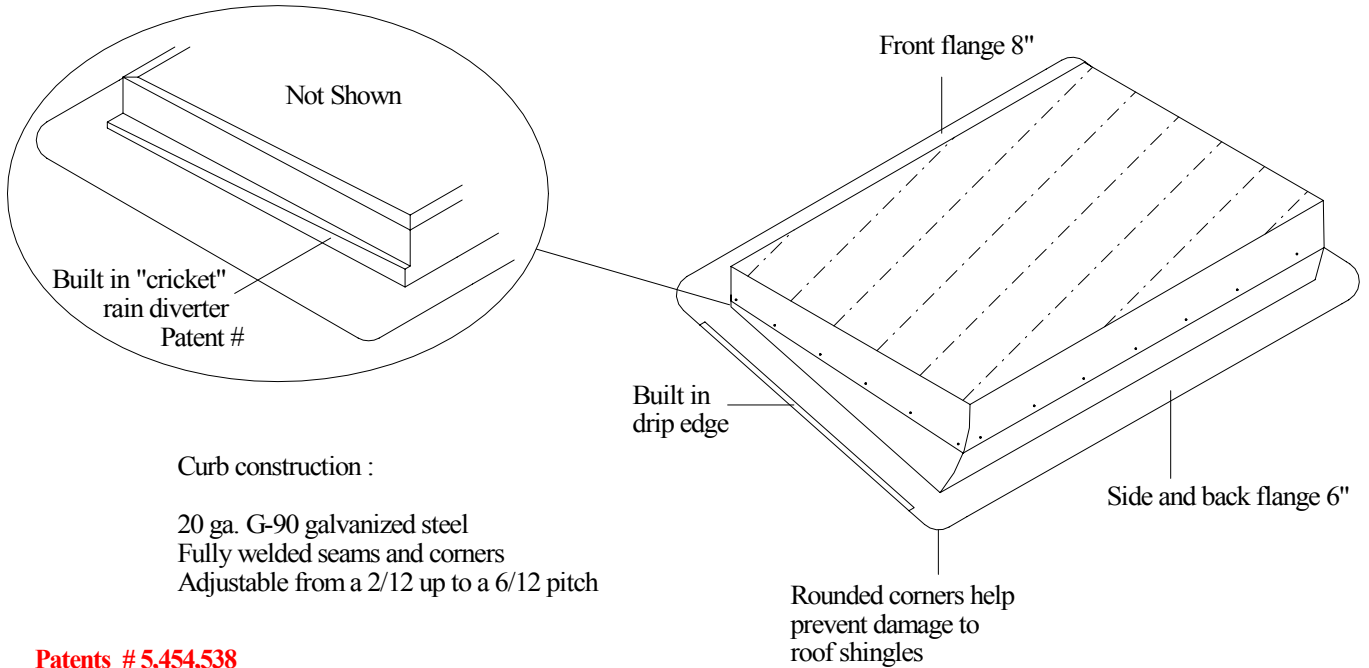

Curb construction :

20 ga. G-90 galvanized steel
Fully welded seams and corners
Adjustable from a 2/12 up to a 6/12 pitch

Patents # 5,454,538
DES. 431174

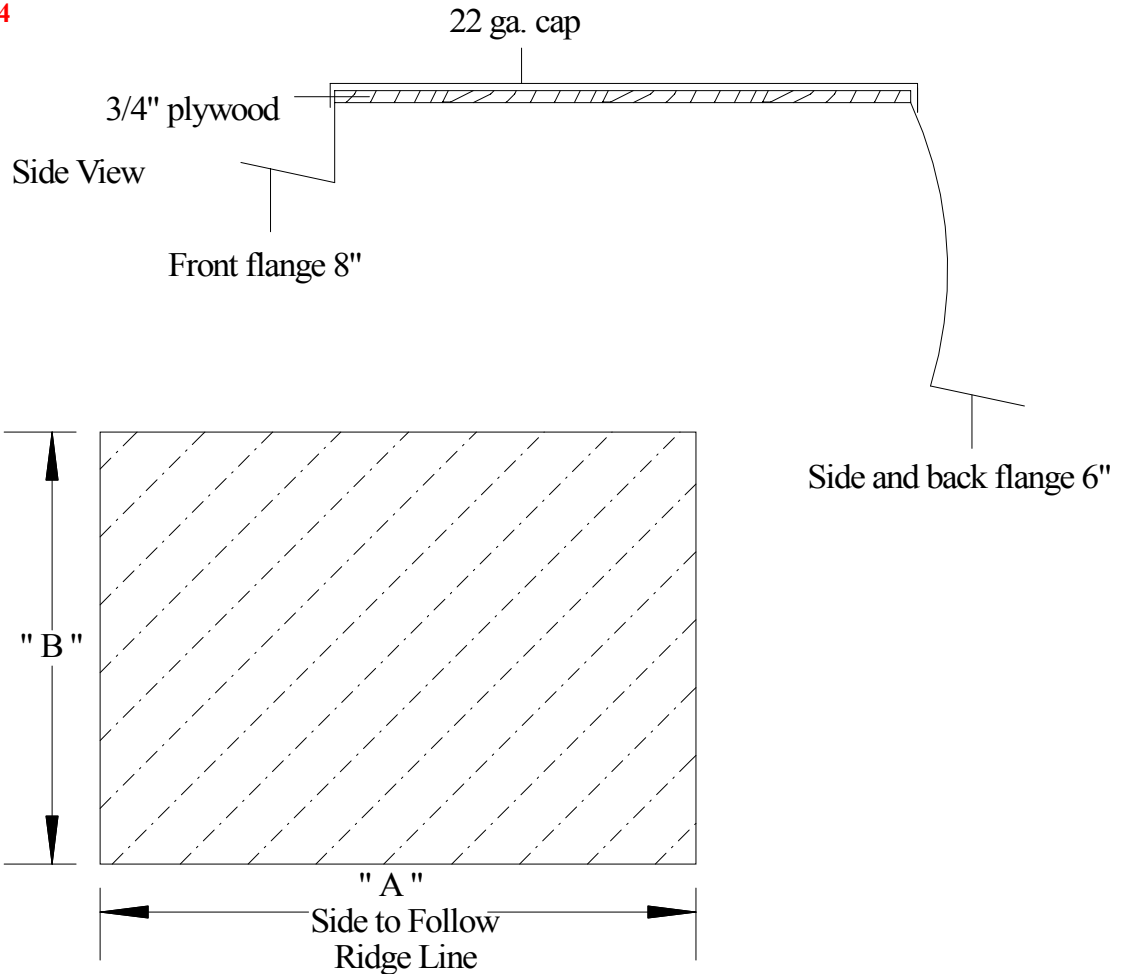

Note:

To create curb product # insert
"A" and "B" dimension into product #
(Insert " A "dimension first)

Product # CON_x_w/cap

UNI-PRODUCTS, INC.

3315 Elkhorn Blvd North Highlands Ca. 95660
(800)369-7017 Fax (916)348-3700

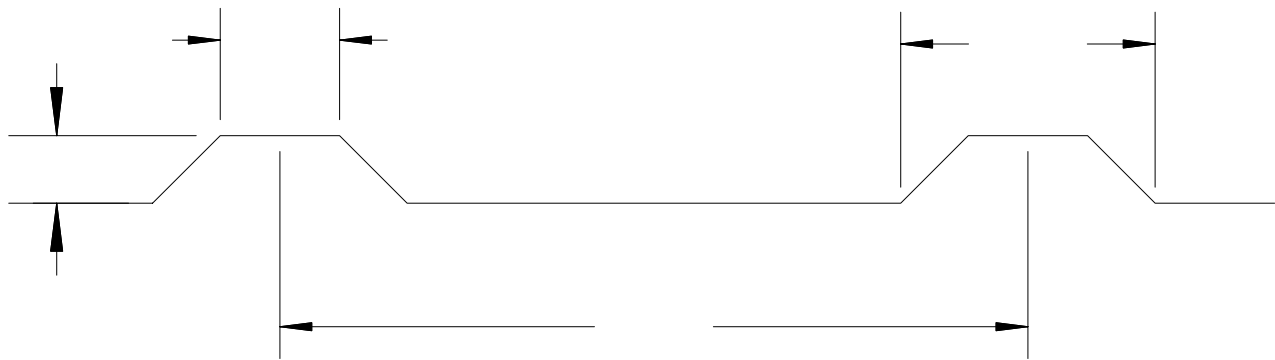
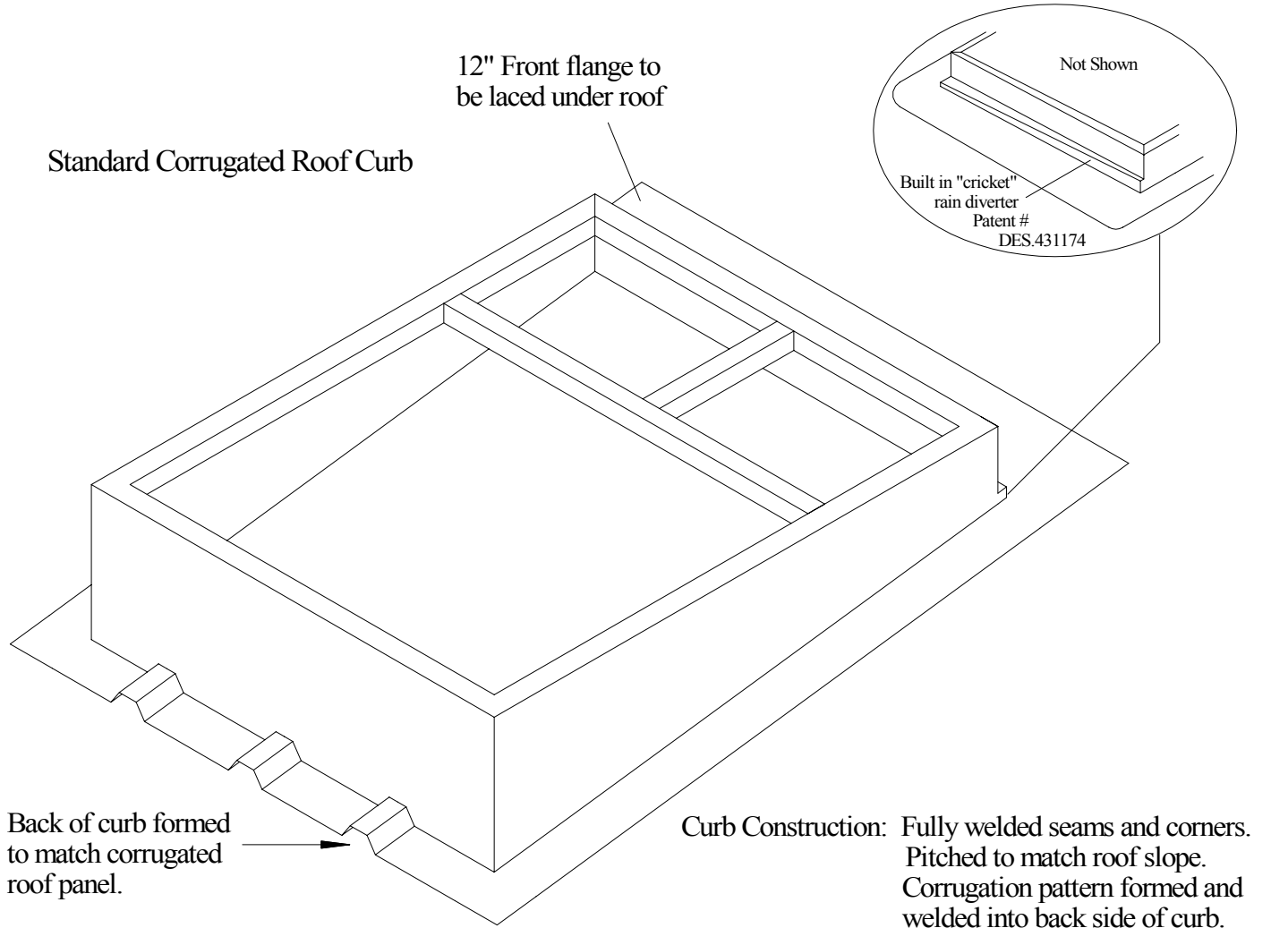

UNI-PRODUCTS, INC.
3315 Elkhorn Blvd North Highlands Ca. 95660
(800)369-7017 Fax (916)348-3700

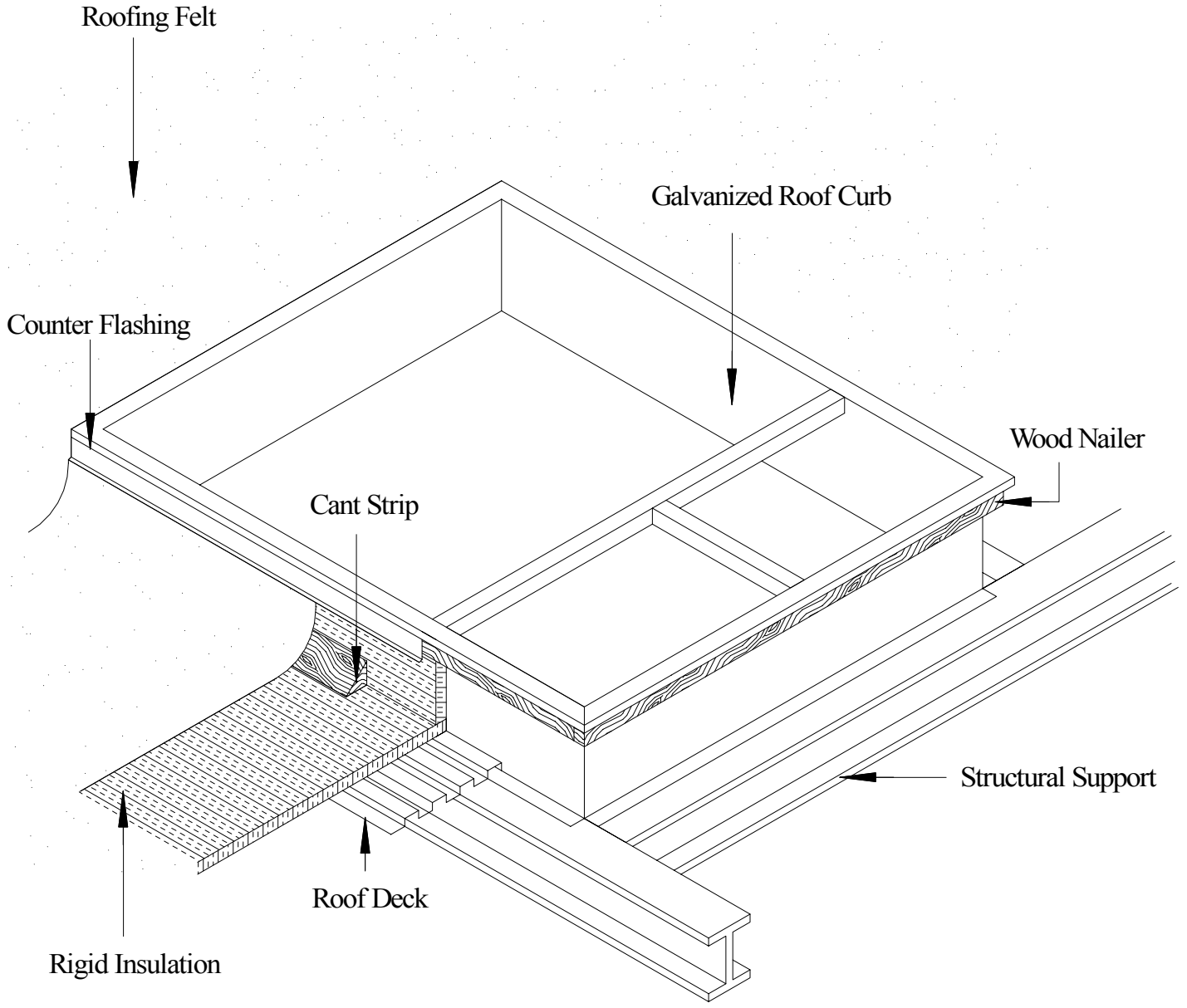

Note: Installation must be done in accordance with state, local and federal codes.